

BASE

AT EXTRACO EVENTS CENTER
BUSINESS ARTS SPORTS ENTERTAINMENT

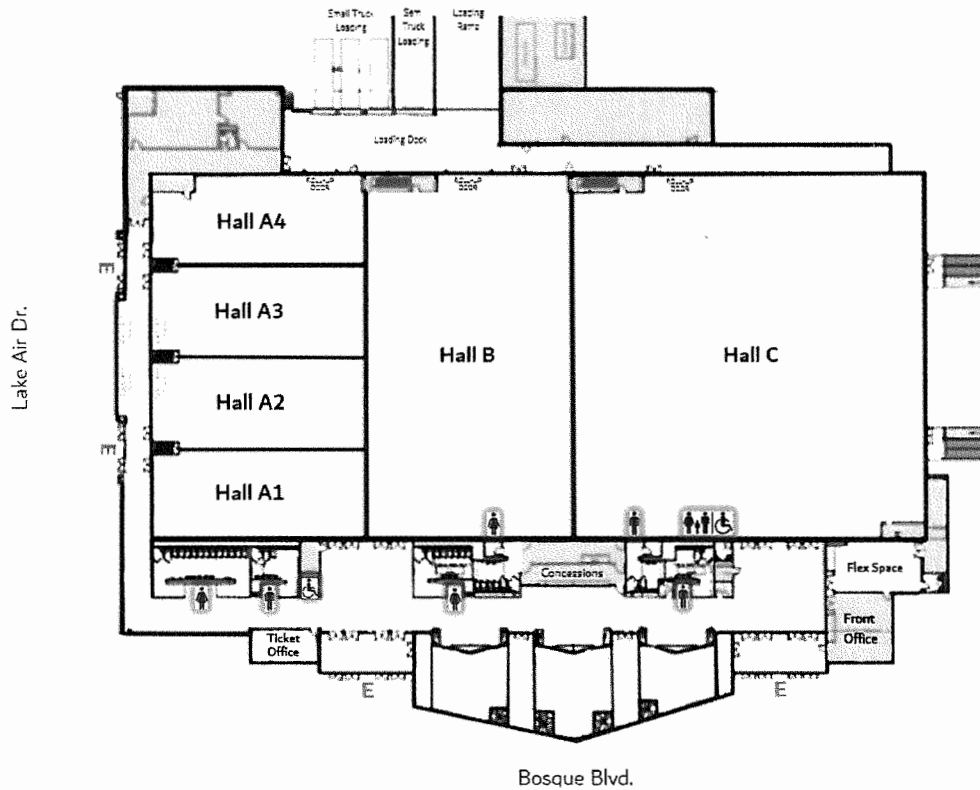

BASE Event Space	Dimensions L x W x H	Square Feet	Max Occupancy	Theater Seating (Max # of People)	Banquet Round Tables (5' (8-10 per))	Banquet Round Tables (6' (10 per))	Banquet Rectangle Tables (8' (8 per))	Classroom Rectangle Tables (8' (4 per))	Vendor Booths Verticle (10' x 10')	Vendor Booths Horizontal (10' x 10')	Amenities	Overhead Door W x H	Loading Ramps & Docks
Meeting Room	29' x 21' x 10'	742	105	48	32	30	32	22			TV		
Ticket Office	28' x 13' x 10'	316	49					12			4 Tic Windows 2 rollup windows		
Hall A	90' x 150' x 30'	14,033	956	956	728	720	800	760	68	68		14' x 14'	2 West Entrance Loading Areas and Loading Dock Access - Back of House (BOH)
Hall A1	32' x 90' x 30'	3,577	241	241	168	140	144	160	12	13			
Hall A2	40' x 90' x 30'	3,561	244	244	224	210	192	200	17	16		14' x 14'	West Entrance Loading Driveway
Hall A3	40' x 90' x 30'	3,561	244	244	224	210	192	200	17	16		14 x 14'	West Entrance Loading Driveway
Hall A4	40' x 90' x 30'	3,334	227	227	224	210	192	200	17	16			
Hall A1-A2	72' x 90' x 30'	7,138	485	485	392	350	336	360	29	29			
Hall A2-A3	80' x 90' x 30'	7,122	488	488	448	420	384	400	34	32			
Hall A3-A4	80' x 90' x 30'	6,895	471	471	448	420	384	400	34	32			
Hall A1-A3	112' x 90' x 30'	10,699	729	729	616	560	528	560	46	45			
Hall A2-A4	120' x 90' x 30'	10,456	715	715	672	630	576	600	51	48			
Hall B	90' x 150' x 30'	13,858	929	929	728	720	800	760	72	68		20' x 15'	Loading Ramp Access - Back of House
Hall A & B	180' x 150' x 30'	27,891	1,885	1,885	1,456	1,440	1,600	1,520	140	136			
Hall C	150' x 150' x 30'	23,869	1,591	1,591	1,248	1,200	1,440	1,200	108	124		14' x 14'	Loading Dock Access - Back of House
Hall B&C	240' x 150' x 30'	37,727	2,520	2,520	1,976	1,920	2,240	1,960	180	192			
HALL A-C	330' x 150' x 30'	52,818	3,476	3,476	2,704	2,640	2,800	2,880	248	260			5 Locations